

# Installation drawing AM4096

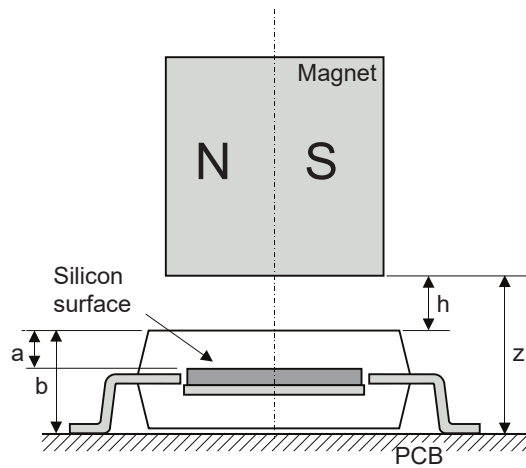

Dimensions and tolerances in mm.

## Magnet position



## Mounting instructions

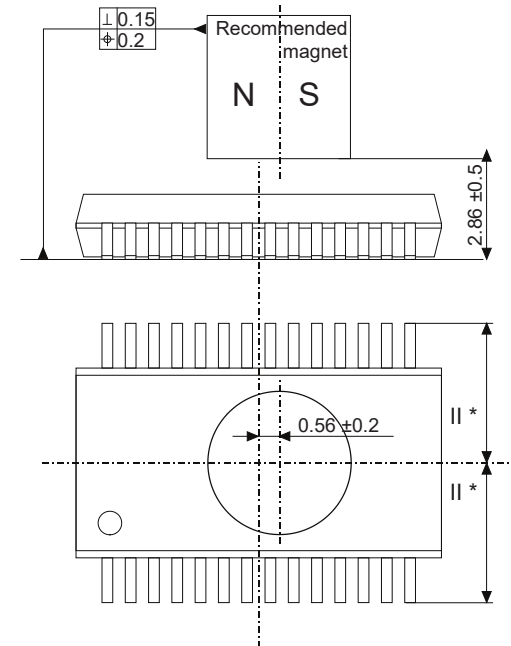

Parameter	Symbol	Min.	Typ.	Max.	Unit	Note
Distance sensors – chip surface	a		0.75		mm	
Distance PCB plane– chip surface	b		1.86		mm	*
Distance chip surface – magnet	h	0.50	1.00	1.50	mm	
Distance PCB plane – magnet	z	2.36	2.86	3.36	mm	*

\* For typical 40 µm copper thickness of PCB